

ART. 0129

G	D _{min}	T _{min}	L _{min}
1/8"	13,0	1,5	16
1/4"	16,5	1,5	17
3/8"	20,0	1,5	19
1/2"	24,5	1,6	21
3/4"	30,0	1,7	25
1"	37,5	1,9	29
1"1/4	46,5	2,2	33
1"1/2	53,0	2,4	37
2"	65,5	2,7	42
2"1/2	82,0	3,2	49
3"	95,5	3,6	54
4"	121,5	4,1	64

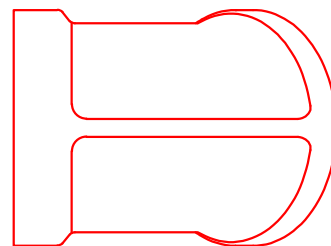
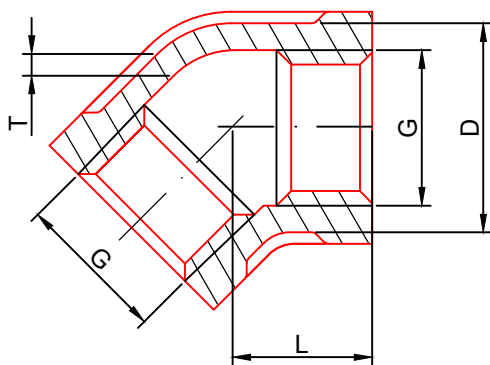

GOMITO 45° FF ISO 4144
ELBOW 45° FF ISO 4144

TECNICATRE
Stainless Steel Experience